

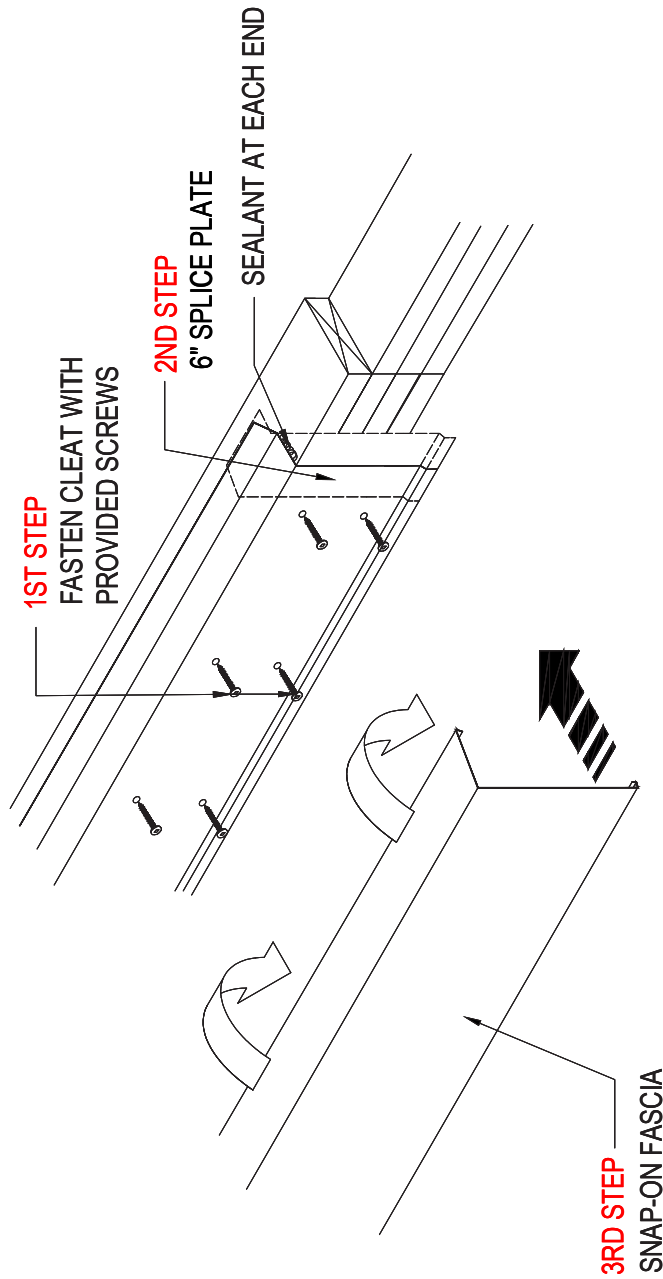

# PERMAEDGE MANUFACTURED BY PRACTICAL METALS

## PERMAEDGE FASCIA INSTALLATION INSTRUCTIONS



### TYPICAL INSTALLATION

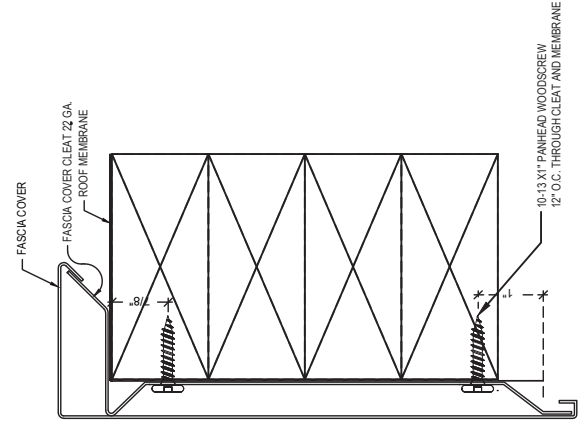

STEP 1, INSTALL 22 GA. FASCIA CLEAT WITH PROVIDED SCREWS FROM MANUFACTURER, INSTALLED 12" O.C. MAKE SURE TO ADD SEALANT AT SEAMS.

STEP 2 INSTALL 6" SPlice PLATE (10' INCREMENTS).

STEP 3 INSTALL SNAP-ON FASCIA: HOOK TOP ON FIRST, PUSHING DOWN UNTIL THE BOTTOM OF THE FASCIA COVER CAN HOOK ON TO THE CLEAT HEM.

**NOTE:** REMOVE PROTECTIVE FILM IMMEDIATELY AFTER INSTALLATION.