

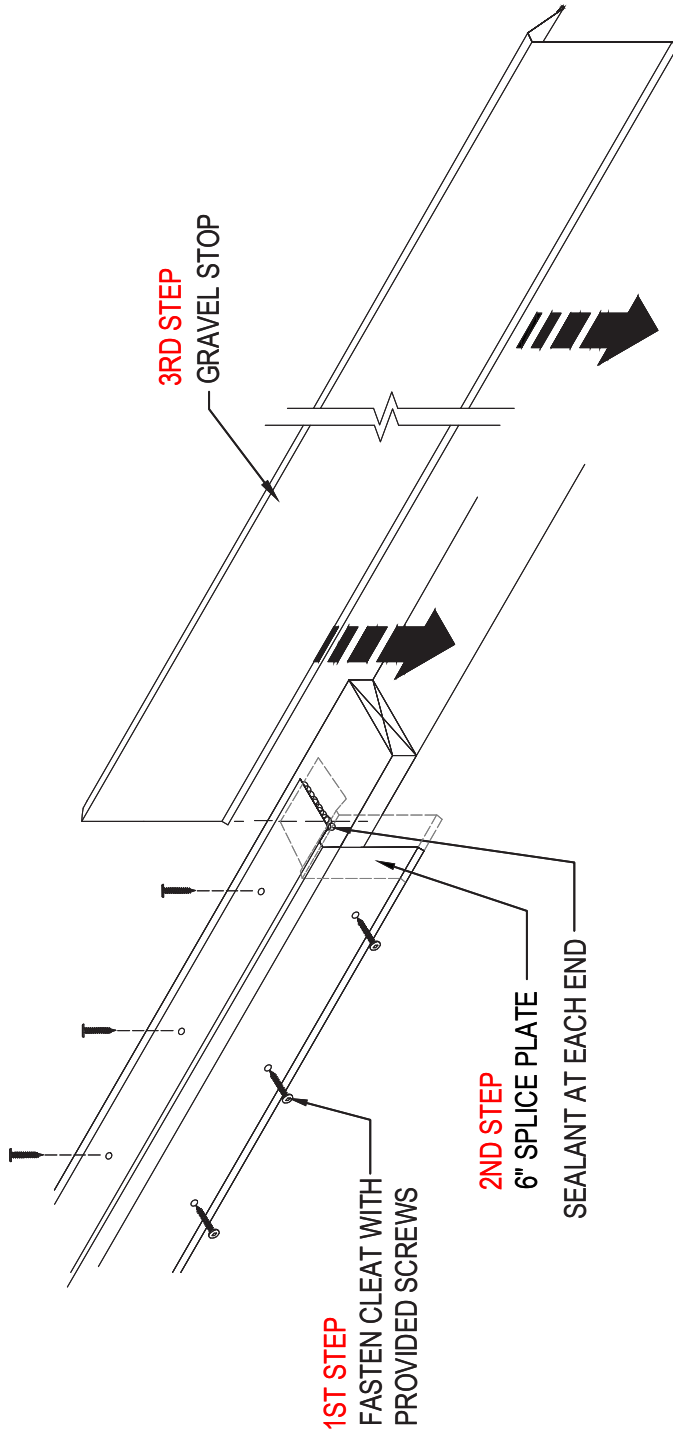

PERMAEDGE MANUFACTURED BY PRACTICAL METALS

PERMAEDGE GS2 INSTALLATION INSTRUCTIONS



TYPICAL INSTALLATION

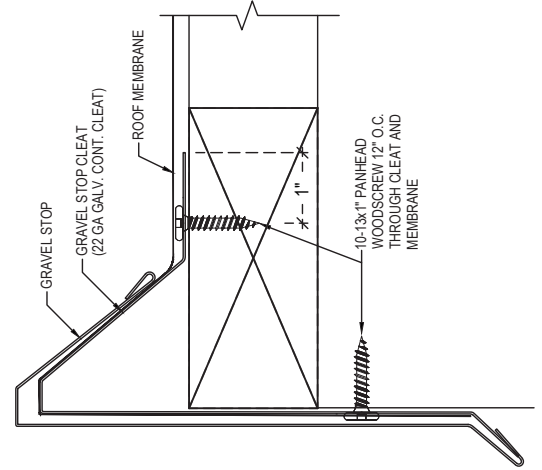

STEP 1, INSTALL 22 GA. GRAVEL STOP CLEAT WITH PROVIDED SCREWS FROM MANUFACTURER. INSTALLED 12" O.C. AND MAKE SURE TO ADD SEALANT AT SEAMS.

STEP 2 INSTALL 6" SPLICE PLATE (10' INCREMENTS).

STEP 3 INSTALL SNAP-ON GRAVEL STOP. (PUSH GRAVEL STOP DOWN UNTIL IT HOOKS INTO THE HEM ON THE CLEAT.

NOTE: REMOVE PROTECTIVE FILM IMMEDIATELY AFTER INSTALLATION.